



FREEBORN SOLAR COMMAND SKIMMER

www.gatesofantares.com

Follow these simple instructions to build your Freeborn Solar Command Skimmer.

Assemble the components in each stage in numerical order. Remove components from the frame with clippers or a craft knife and trim away excess plastic before assembling. Test fit all parts before applying glue. Un-numbered parts are not used to build this model.

We recommend using polystyrene cement to assemble the plastic parts of the model and superglue (cyanoacrylate) to add the metal and resin components.



Areas marked with this symbol should not be glued, to allow parts of the model to rotate.

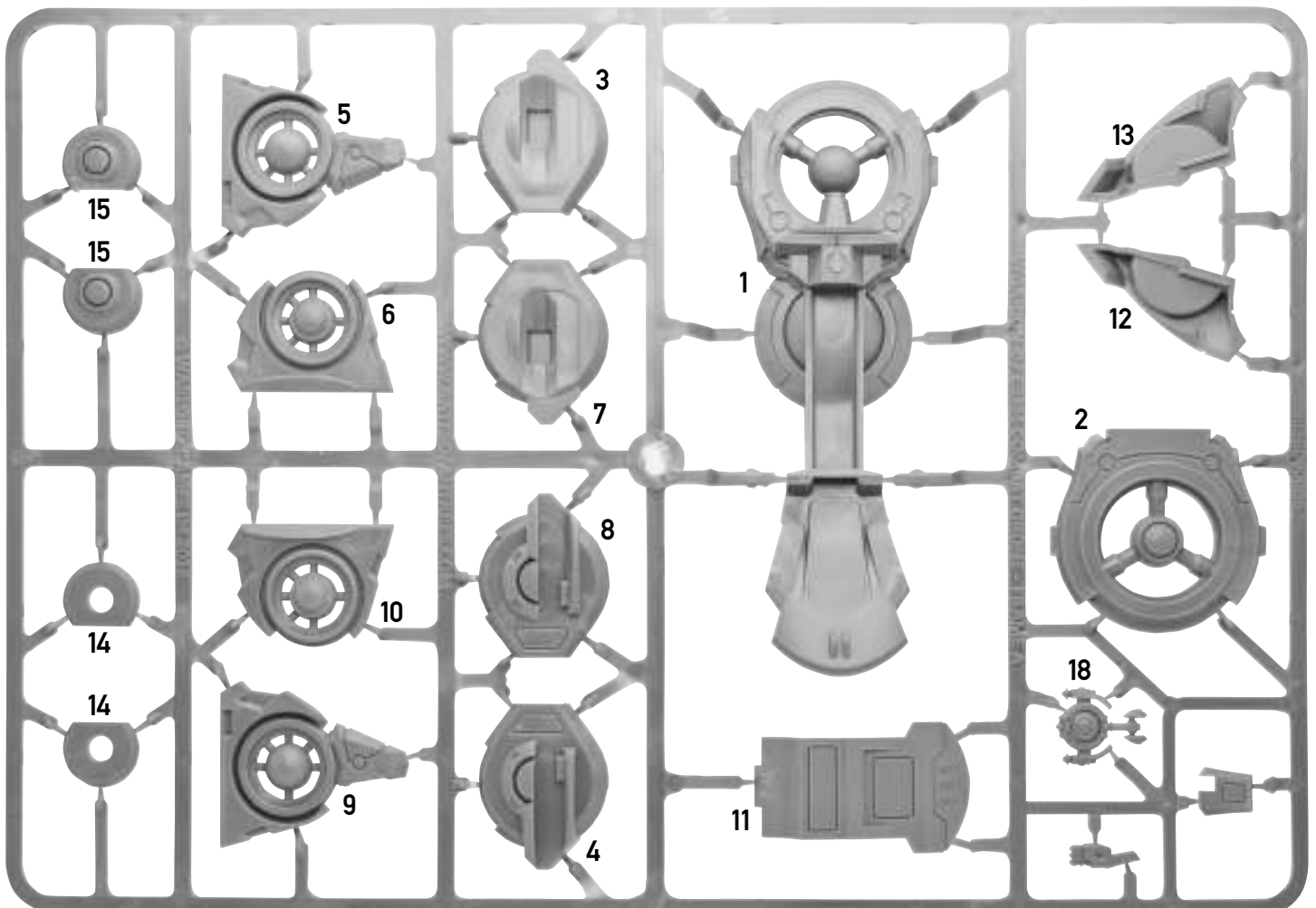
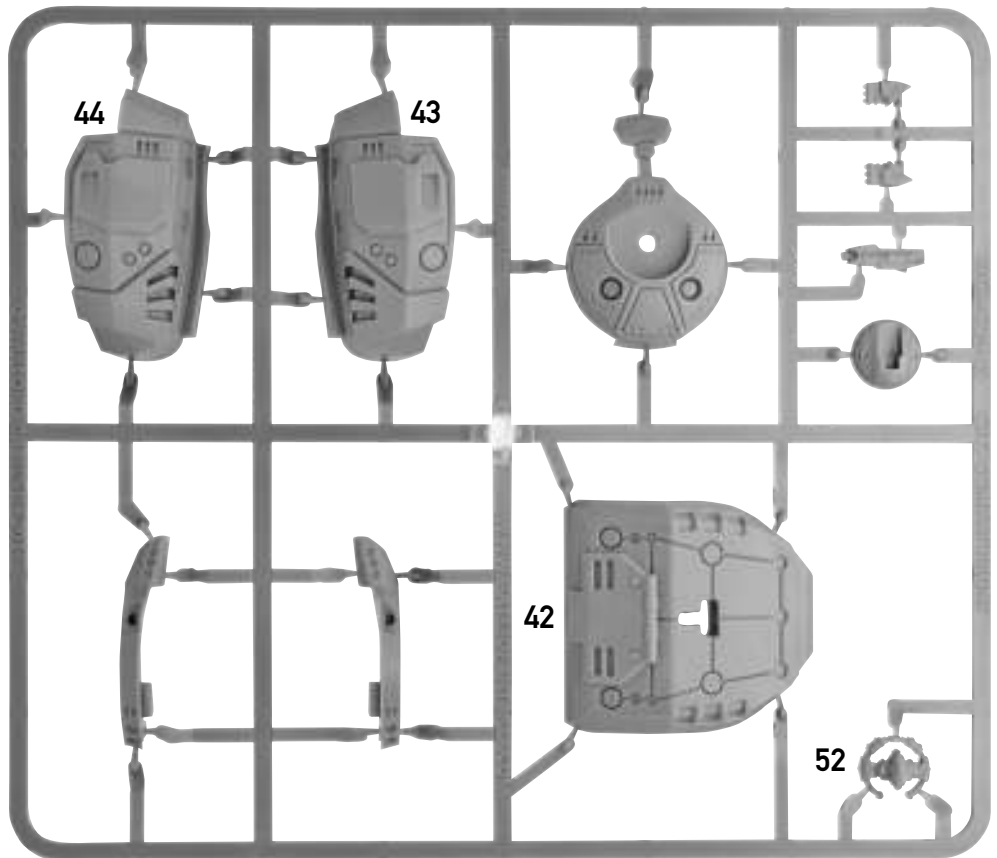

Component code: 5070500001

